

BP-2, FLOOR PLAN, THIRD FLOOR

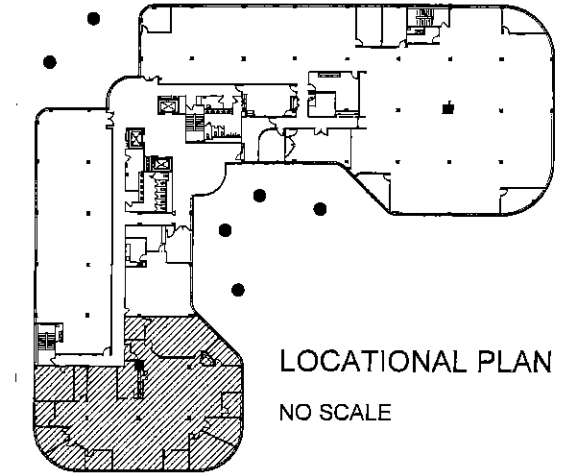

- NOTES:
- DETAILS & NOTE/SPECS. ARE NUMBERED WITH THE MASTERFORMAT SYSTEM OF CONSTRUCTION CLASSIFICATION. THE FIRST PART OF EACH NUMBER IS THE MASTERFORMAT SECTION NUMBER. WHERE THERE IS A LETTER AT THE END OF THE NUMBER, IT INDICATES THE TYPE (I.E. DOOR TYPE).
- FOR ABBREVIATIONS & SYMBOLS, SEE NOTE/SPEC. 01070-1.
- [A] PARTITION/WALL TYPES- SEE NOTE/SPEC. 09250-2. SOLID SHADED WALLS & COLUMNS ARE EXISTING TO REMAIN. PARTITIONS WITH HEAVY LINES ARE NEW. NEW PARTITIONS WITHOUT A TYPE NOTED ARE TYPE "A".
 - ⊕ DOOR TYPES FOR NEW DOORS- SEE NOTE/SPEC. 08000-1. DOORS WITHOUT A TYPE INDICATED ARE EXISTING DOORS TO REMAIN.
 - ⊕ SIDELIGHT & BORROW LIGHT TYPES- SEE NOTE/SPEC. 08500-2. SIDELIGHTS & BORROW LIGHTS WITHOUT A TYPE INDICATED ARE EXISTING SIDELIGHTS & BORROW LIGHTS TO REMAIN.
 - ⊕ DUPLEX OUTLET; "D" INDICATES DEDICATED OUTLET
 - ⊕ DOUBLE DUPLEX OUTLET
 - ⊕ LIGHT SWITCH; "D" IS DIMMER; "O" IS OCCUPANCY SENSOR
 - ⊕ FIRE ALARM STROBE/HORN
 - ⊕ THERMOSTAT
 - ⊕ ELECTRICAL JUNCTION ⊕ SYSTEMS PANELS
 - ⊕ TELEPHONE/DATA OUTLET
 - ⊕ TEL./DATA OUTLET ⊕ SYSTEMS PANELS
- "N" INDICATES NEW OR RELOCATED DEVICE; ALL OTHER DEVICES ARE EXISTING DEVICES TO REMAIN.

These documents, prepared by Ambrose Design Group, P.C., are instruments of professional service. They are intended for use only with the parties, project, and location specifically described herein.

FHWA
Tenant Improvements
 Glastonbury Corporate Center
 Suite 303, 628-2 Hebron Avenue, Glastonbury, CT

Property Manager
GRUNBERG MANAGEMENT
 628 Hebron Ave., Glastonbury, CT 06033, Tel.: (860)659-8263, Email: il@grunbergmanagement.com

99 Pratt Street, Hartford, CT 06103, Tel. (860)727-8031, Email adg@ambrosedg.com